

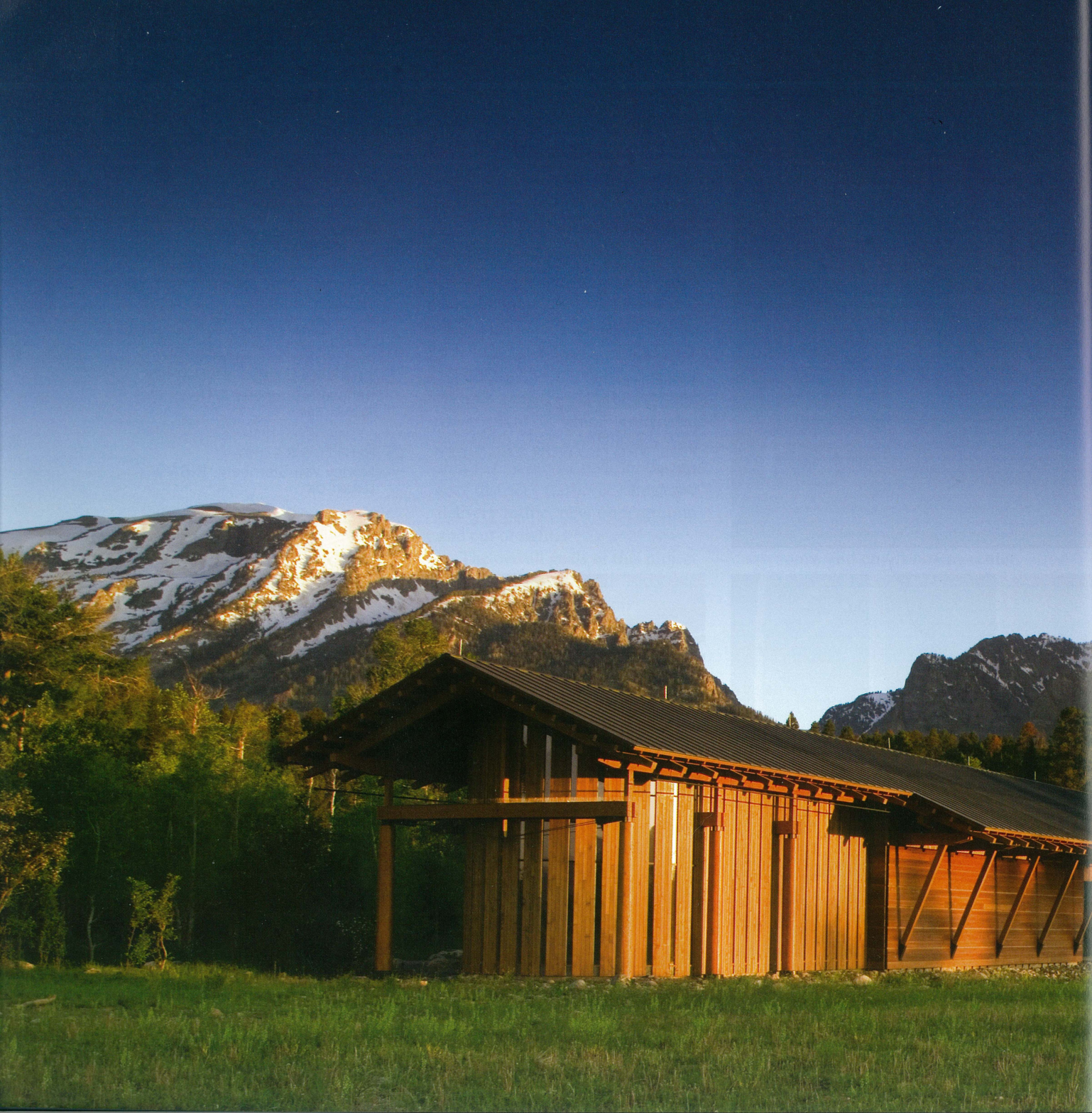

CELEBRATING EXCELLENCE IN WOOD STRUCTURES
2009-10 NORTH AMERICAN WOOD DESIGN AWARD WINNERS



The Laurance S. Rockefeller (LSR) Preserve embodies the vision of its namesake to inspire appreciation for nature and to foster stewardship of the land.

Laurance S. Rockefeller Preserve

Carney Logan Burke Architects



"This is a simple, elegant exterior volume, with a varied use of wood. It's very refined. The building is broken apart and well-considered in terms of views and use of the land."

— JURY

A feather float on Pringle Lake —

a cradle of light
rocking with the breeze



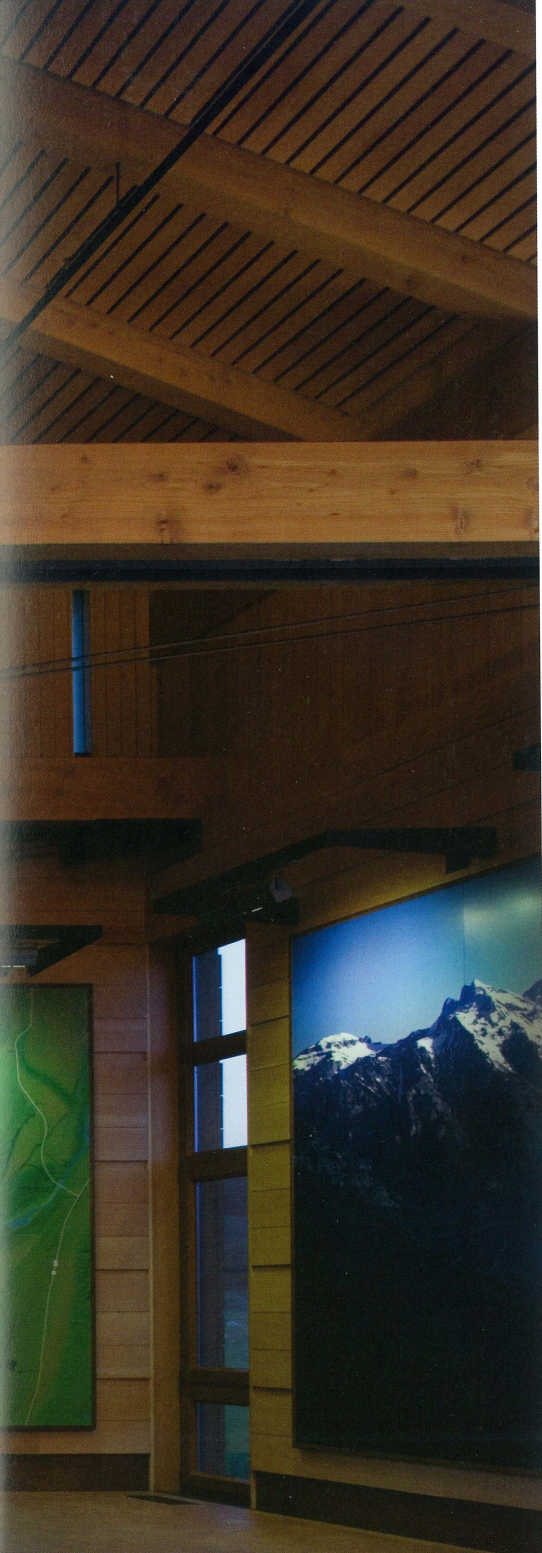

This groundbreaking project started with a gift from Laurance S. Rockefeller to the American people: a 1,100-acre in-holding in Grand Teton National Park that had been a family retreat for more than 75 years. Mr. Rockefeller's concept was to remove the family compound of 35 structures from the shores of Phelps Lake and create a network of trails linking a new interpretive center at the south end of the site to the lake at the north. After the project was completed it was turned over to the National Park Service in June 2007.

Every aspect of the building and site was designed to reinforce a message of stewardship, conservation, and the power of nature to restore the soul. In addition to the 7,000-sq.ft. interpretive center, the project included parking, three restroom outbuildings with composting toilets, and a major reclamation effort to remove all former roads, horse trails, and other signs of human development. The center was the first LEED Platinum building in the National Park Service and in Wyoming. Through its design and program the center advances environmental responsibility on every level.

The overall mission of the project inspired the design team to envision the building as a kind of secular chapel, a place to quiet the mind and open the senses to the experience of nature. Wood was chosen as the primary material for the struc-

tures to invoke the memory of the original structures without being imitative, and to use building systems that would have a chance to achieve LEED Platinum. The building program includes a welcome and orientation area, exhibit galleries and a resource library. The exhibits tell the Rockefeller family story and prepare visitors for their hike by highlighting visual, auditory, and tactile qualities of the preserve's flora and fauna. The resource library provides a place for visitors to relax and learn about the preserve. Comfortable seating, tables, chairs, and lighting, all designed by the architects, invite visitors to explore books, albums, and maps about the preserve, and learn more about the ecology of the region.

The design of the center reflects a timeless aesthetic, with wood, stone, zinc, and oxidized steel chosen for their durability and connection to the site and region. A message of simplicity and economy of use is reinforced by the limited palette of materials both inside and out. The structural system consists primarily of a FSC Douglas fir timber-frame, coupled with highly recycled insulated concrete form (ICF) bearing walls. The frame itself is comprised of 16-in. diameter turned log columns with a more traditional sawn timber-frame roof structure above. The roof structure is a layered system of 2x sub-rafters and 3x sub-purlins over 6 x 10 rafters and 6 x 12 purlins, all of which are supported by custom composite wood and steel king post

trusses inspired by the property's historic boathouse.

The ICF bearing walls are clad on the exterior with a rain-screen of FSC clear 2 x 12 custom profiled T&G Western red cedar horizontal siding, which transforms to a clear vertical grain 1 x 12 custom profiled T&G horizontal Douglas fir paneling on the interior.

The interior materials reflect a more refined aesthetic and sense of detail which is demonstrated in the 1 x 4 square edge vertical wall paneling, 1-in. standing and running trim, built-in cabinetry and custom designed furniture found throughout the center – all manufactured and fabricated from FSC clear vertical grain Douglas fir. Acoustic dampening ceilings in between rafters are finished with gapped 1 x 4 square edge clear reclaimed hemlock.

A generous south facing covered porch with custom fabricated Adirondack chairs of the same Western red cedar as the exterior cladding invokes the spirit of old ranch structures and provides a place for park rangers to give talks about the site and the project.

The combined effect of the architecture and the exhibits allows visitors to experience a spiritual and emotional connection to the natural beauty of the site and prepares them for an inspiring hike to Phelps Lake.

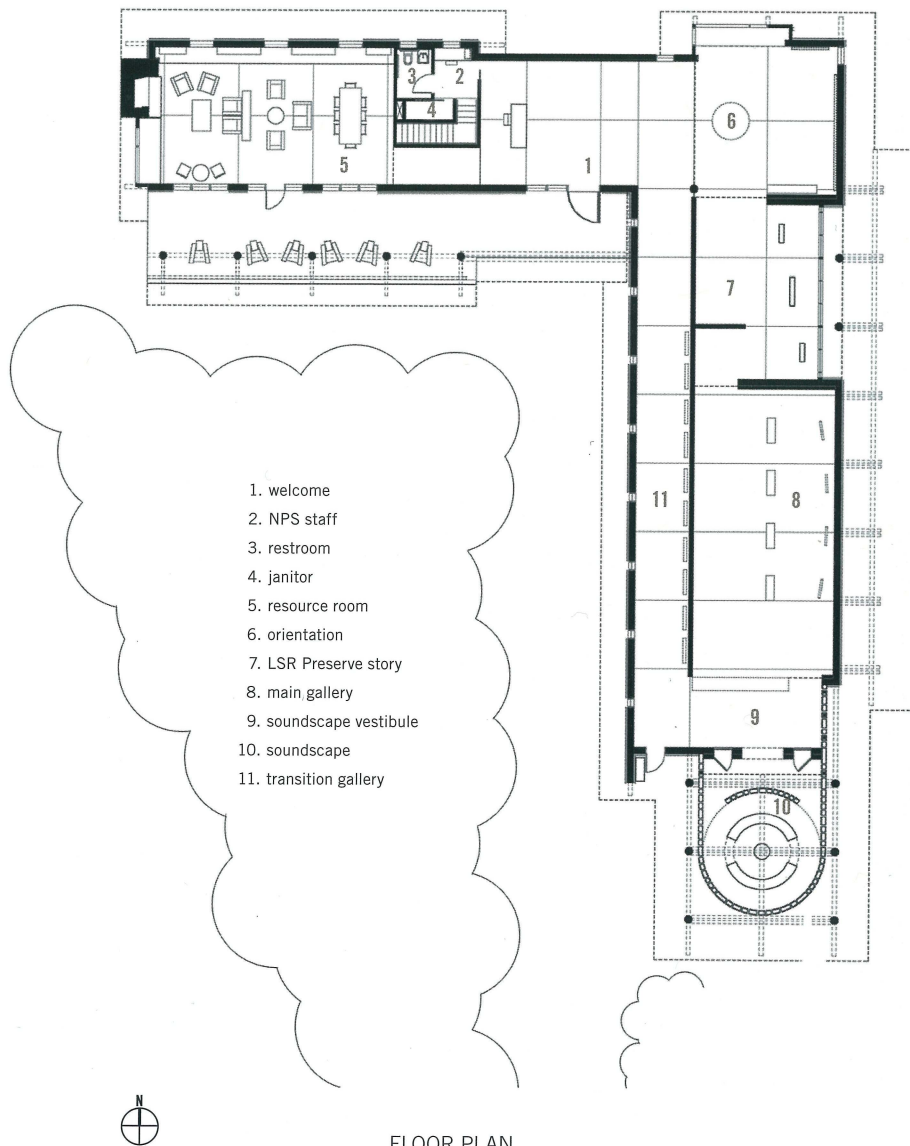

FLOOR PLAN



ARCHITECT
Carney Logan Burke Architects
Jackson, WY

CLIENT
Grand Teton National Park
Moose, WY

GENERAL CONTRACTOR
GE Johnson Construction Company
Jackson, WY

STRUCTURAL ENGINEER
KL&A of Colorado
Golden, CO

TIMBER FRAME AND WOOD
PRODUCTION
Spearhead Timberworks
Nelson, BC

LANDSCAPE DESIGNER
Hersberger Design
Jackson Hole, WY

PHOTOGRAPHY
Paul Warchol Photography Inc.
New York, NY

Nic Lehoux
Vancouver, BC

